

DATA SHEET

FOR RIVETS ALUMINIUM/STEEL WITH DOMEHEAD

Rivet: Aluminium AlMg 3.5
Mandrel: steel zincplated
UNE-EN ISO 15977

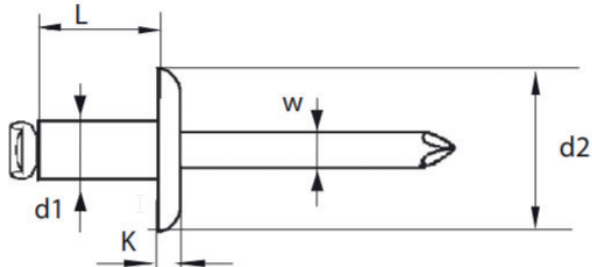

d1 = diameter of rivet
L = length of rivet
d2 = diameter of head
K = height of head
w = diameter of mandrel
E = grip length



d1	L	d2	K	w	E	Item nr.
4.0	6	8.0	1.4	2.2	1.0-3.0	55924006
	8				3.0-5.0	55924008
	12				6.5-8.5	55924012
	14				8.5-10.5	55924014
	16				10.5-12.5	55924016
	18				12.5-14.5	55924018
	25				16.5-21.5	55924025
4.8	6	9.5	1.5	2.65	0.5-3.0	55924806
	8				3.0-4.5	55924808
	12				6.0-8.0	55924812
	16				10.0-12.0	55924816
	18				12.0-14.0	55924818
	21				14.0-17.0	55924821
	24				17.0-20.0	55924824
5.0	8	9.5	1.6	2.5	3.0-4.5	55925008
	16				10.0-12.0	55925016
	18				12.0-14.0	55925018
	25				16.0-21.0	55925025

specifications in mm

Load capacity of the assembly for sheering strain/ tensile strain:

4.0: 1.250N / 1.800N
4.8: 1.850N / 2.600N
5.0: 2.150N / 3.100N

DATENBLATT

FÜR FLACHRUNDKOPF BLINDNIETEN AUS ALUMINIUM/STAHL

Niethülse: Aluminium Al Mg 3,5
Dorn: Stahl, verzinkt A1K
UNE-EN ISO 15977

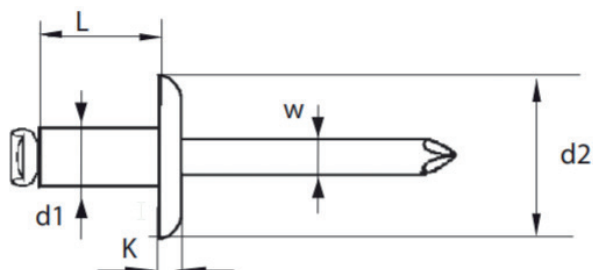

d1 = Durchmesser der Niete
L = Länge der Niete
d2 = Durchmesser des Nietkopfs
K = Höhe des Nietkopfs
W = Durchmesser des Dorns
E = möglicher Klemmbereich

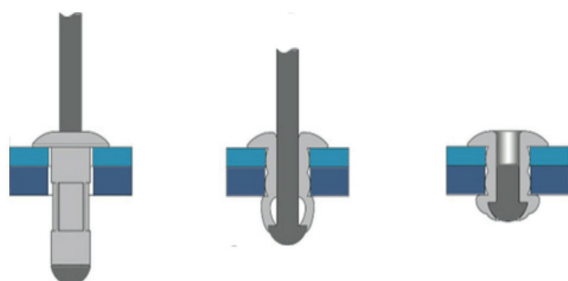

d1	L	d2	K	w	E	Art.-Nr.
4,0	6	8,0	1,4	2,2	1,0-3,0	55924006
	8				3,0-5,0	55924008
	12				6,5-8,5	55924012
	14				8,5-10,5	55924014
	16				10,5-12,5	55924016
	18				12,5-14,5	55924018
	25				16,5-21,5	55924025
4,8	6	9,5	1,5	2,65	0,5-3,0	55924806
	8				3,0-4,5	55924808
	12				6,0-8,0	55924812
	16				10,0-12,0	55924816
	18				12,0-14,0	55924818
	21				14,0-17,0	55924821
	24				17,0-20,0	55924824
5,0	8	9,5	1,6	2,5	3,0-4,5	55925008
	16				10,0-12,0	55925016
	18				12,0-14,0	55925018
	25				16,0-21,0	55925025

Angaben in mm

Belastbarkeit der Nietverbindung auf Scherung / Zug:

4,0: 1.250N / 1.800N
4,8: 1.850N / 2.600N
5,0: 2.150N / 3.100N